

# TECH DATA SHEET

## PROJOINT™ PORCELAIN FLEXIBLE PAVING GROUT



### PREPARATION:

To help achieve the best results, we recommend using the PAVECARE PRE-GROUT SEALER prior to grouting. Ensure that the paving is firmly fixed and the joints are clean, free of dust, excess adhesive, bedding mortar or any contamination. Do not use in wet weather or if frost is forecast within 72 hours of application. The bedding mortar must be fully cured to avoid adverse effects of excess moisture. PROJINT PORCELAIN GROUT is suitable for use on surface temperatures between 5°C and 25°C. Do not apply to areas in direct sunlight or to substrates that are hot. ProJoint Porcelain Grout should be mixed with 275ml of cold clean water per 1kg of grout. For ease of installation, we recommend smaller mixing quantities.

- 1: Remove the bags from the tub and add the measured quantity of water.
- 2: Slowly add the measured amount of powder.
- 3: Mix for 2 minutes using a drill and paddle/plasterers' whisk, until a smooth creamy consistency is reached.
- 4: Allow to stand for 2 minutes. This process allows the polymer additives to dissolve and activate.
- 5: Re-mix for 2 minutes. Do not re-wet or add too much water as this may cause a weakening of the grout and may also lead to discolouration in the form of efflorescence.

### APPLICATION INSTRUCTIONS:

- 6: Use a rubber float to work the grout deeply into the joints until flush with the paving. Excess grout should be removed as work proceeds.
  - 7: Any final residues left on the tile face can be removed by wiping off with a damp sponge up to 30 minutes after application. Ensure you have plenty of clean water for removing grout whilst wet/damp.
  - 8: We recommend the use of a washboy and sponge float to clean the grout residue from the surface of the porcelain and provide a smooth finish on the joints. Textured paving may need additional cleaning to remove once dry. Any dusty film remaining on the surface can be removed by polishing off with a damp cloth when the grout is starting to harden in the joints. Depending on the paving, this may require multiple polishes. Care should be taken not to use excess water or additional water after cleaning off, to avoid damaging the joints.
- These are dependent on temperature and humidity, but as a guide can accept foot traffic after 3 hours at 20°C and a full cure after 72 hours at 20°C - protection from rain will be required in this time. Please note that cold temperatures can delay the curing time.

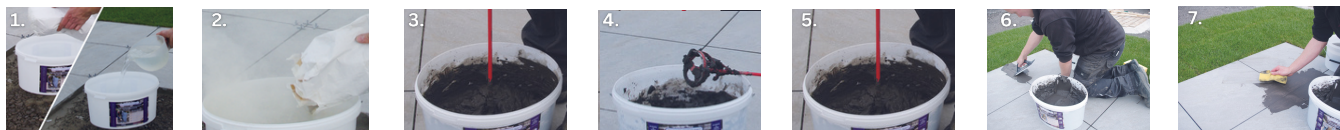

### HEALTH AND SAFETY ADVISORY

Contains Biocide: 2-OCTYL-2H-ISOTHIAZOL-3-ONE may cause an allergic skin reaction.

**HAZARD STATEMENTS:** H315 Causes skin irritation. H317 May cause an allergic skin reaction. H318 Causes serious eye damage. H335 May cause respiratory irritation.

**PRECAUTIONARY STATEMENTS:** P271 Use only outdoors or in well-ventilated areas. P280 Wear protective gloves/protective clothing/eye protection/face protection. P302+352 IF ON SKIN: wash with plenty of water. P304+340 IF INHALED: remove person to fresh air and keep comfortable for breathing. P305+351+338 IF IN EYES: rinse cautiously with water for several minutes. Remove contact lenses, if present and easy to do. Continue rinsing. P310 Immediately call a poison centre/doctor. P501 Dispose of contents/container in accordance with local regulations.

### APPLICATION IMAGERY

SYSTEM	HIGH PERFORMANCE EXTERIOR AND INTERIOR PORCELAIN PAVING GROUT
STORAGE	STORE IN A COOL, DRY, AND FROST FREE ENVIRONMENT AT TEMPERATURES BETWEEN 5°C AND 30°C
SHELF LIFE	12 MONTH FROM DATE OF MANUFACTURE
PACKAGING	20KG TUBS DELIVERED ON SHRINK-WRAPPED PACKAGING
PALLET QUANTITY	44 UNITS
COVERAGE	AS SHOWN ON COVERAGE TABLE
COLOURS	N/A
WALK ON CURING TIME	12 HOURS IN DRY AMBIENT CONDITIONS
FULL STRENGTH	28 DAYS
SUB BASE REQUIREMENT	FULL SOLID BED - CEMENT BASE SHOULD BE FULLY CURED BEFORE APPLICATION OF GROUT



AVAILABLE IN FOUR VERSATILE COLOURS

## KEY FACTS:

- ✓ PROFESSIONAL STRENGTH
- ✓ DEVELOPED FOR JOINT WIDTHS OF 2-20MM
- ✓ SUITABLE FOR EXTERNAL AND INTERNAL USE
- ✓ WATER AND MOULD REPELLENT

### APPROXIMATE COVERAGE PER 20KG TUB

Joint Size	1200 x 600mm slabs	600 x 600mm slabs	900 x 220mm slabs
4 x 20mm	62.5M <sup>2</sup>	47.17M <sup>2</sup>	27.47M <sup>2</sup>
5 x 20mm	50.0M <sup>2</sup>	37.31M <sup>2</sup>	22.12M <sup>2</sup>
6 x 20mm	41.68M <sup>2</sup>	31.25M <sup>2</sup>	18.38M <sup>2</sup>

## BRUTE STRENGTH PAVING PRODUCTS

