



Regupol®

# TECHNICAL DATA SHEET

## UNDERFLOOR HEATING OVER REGUPOL® 4515 MULTI

### PRODUCT DESCRIPTION

Regupol® 4515 Multi is a tough, resilient, acoustic underlay that has been developed to attenuate impact sound beneath a wide range of floor finishes, including carpet, wood, laminates and tiles in concrete construction.

Achieving superior impact sound attenuation with any floor finish, Regupol® 4515 Multi delivers high tensile strength and exceptional acoustic performance without ageing or collapsing.

### BENEFITS

- Suitable for all floor finishes including ceramic, granite, stone and marble tiles
- Offers long term performance without collapse or “bottoming” out under high point loads
- Resistant to ageing and deformation
- Quick and easy to install. Simply bond to the subfloor beneath the final floor finish
- Zero global warming potential (GWP) & zero ozone depletion potential (ODP)
- Independent Test Data available for both site and field tests to show compliance with both Approved Document E and Section H of the Building Regulations
- Product manufactured using Recycled Materials and 100% recyclable
- Suitable for all types of underfloor heating



### APPLICATIONS

Regupol® 4515 Multi is widely used in developments where effective sound control is essential and interior design flexibility is a priority. These include:

- Apartments
- Education developments
- Hotels
- Commercial developments
- Leisure developments
- Bespoke architectural projects

[WWW.CMSDANSKIN.CO.UK](http://WWW.CMSDANSKIN.CO.UK)

**CMSDANSKIN**  
ACOUSTICS

## PHYSICAL INFORMATION

Roll width	1000mm
Roll lengths	20m (3mm) & 18m (4.5mm)
Material thickness	3mm & 4.5mm as standard
Material construction	PUR foam/cork

## TECHNICAL INFORMATION

Density	approx 420kg/m <sup>3</sup>
Tensile strength (DIN 53571)	approx 0.7N/mm <sup>2</sup> (4.5mm material)
Elongation at break (DIN 53571)	approx 25%
Temperature resistance	-40°C to +110°C
Impact sound insulation $\Delta L_W$	18dB
* Tog Rating	3mm 4515 Multi - 0.39 (Mean Value) 4.5mm Multi - 0.54 (Mean Value)
Thermal conductivity W/mk	3mm 4515 Multi - 0.086 (Mean Value) 4.5mm 4515 Multi - 0.089 (Mean Value)

## INSTALLATION SERVICE

In addition to supply of this product CMS Danskin Acoustics can provide a listing of competitively priced approved installers that service anywhere in the UK. Use of this service ensures that installation is performed to the highest standards by tradesmen fully experienced in the specialist skills of fitting CMS Danskin acoustic materials correctly. Please contact your local CMS Danskin Acoustics for a list of approved and qualified installers.

**Full installation guidelines are available on request.**

**However, key points to observe are:**

1. Area of installation must be dry and weather tight
2. Regupol® 4515 Multi should be unwound and left for a minimum 8 hours or ideally overnight at the place where it is to be installed, to allow for any potential shrinkage.
3. The subfloor must be sound, smooth and dry. A self-levelling compound may be required to bring the floors up to the necessary levels. Please call for further information.\*\*

\*\* Regupol® 4515 acoustic underlays can be easily installed providing BS8203 is observed at all times.

Product thickness selected is based on acoustic performance required.

## SOLID FLOOR SYSTEM

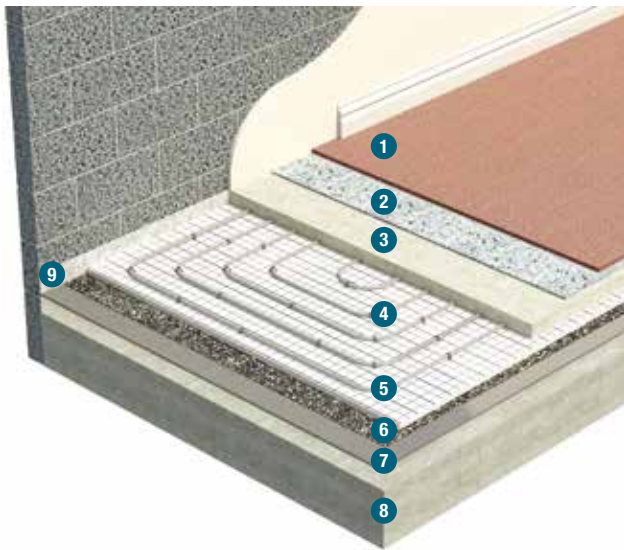

The solid floor system is compatible with a variety of floor finishes including tile, carpet and timber. Acoustically treated by the introduction of a Regupol® resilient layer.

1. Final floor finish
2. Underlay
3. Screed system (min coverage 30mm over pipes)\*
4. 15mm diameter polybutylene pipe
5. Insulation board (min 25mm)
6. Regupol® 4515 Multi resilient layer
7. Regupol® Regubond 100
8. Concrete sub floor
9. Perimeter edge insulation

## RECESSED BOARD SYSTEM UTILISING A PRE-GROOVED INSULATION PANEL

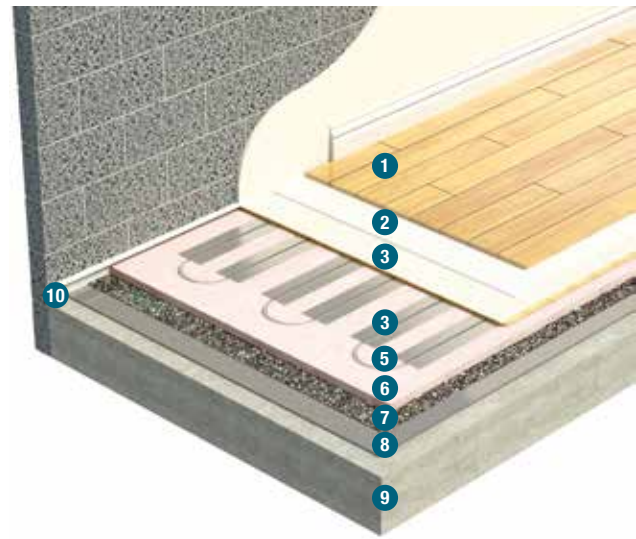

Within the recessed board system, heat emission plates are introduced to increase the radiated surface area. Acoustically treated by the introduction of Regupol® resilient layer.

The recessed board system is reliant on a completely flat and level floor surface prior to application. This may require a levelling screed.

1. Final floor finish
2. Underlay
3. Separating layer (chipboard or Versapanel®)
4. 15mm diameter polybutylene pipe
5. Heat emission plates
6. Pre-grooved insulation board
7. Regupol® 4515 Multi resilient layer
8. Regupol® Regubond 100
9. Concrete sub floor
10. Perimeter edge insulation

## INSTALLATION

### PRECAST FLOOR

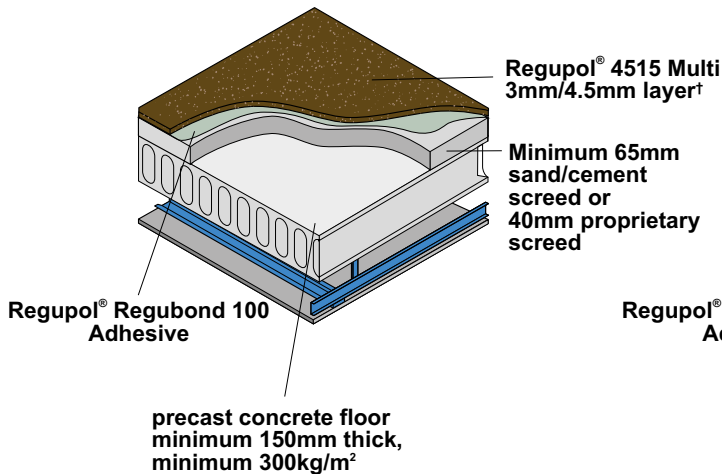

### BEAM & BLOCK FLOOR

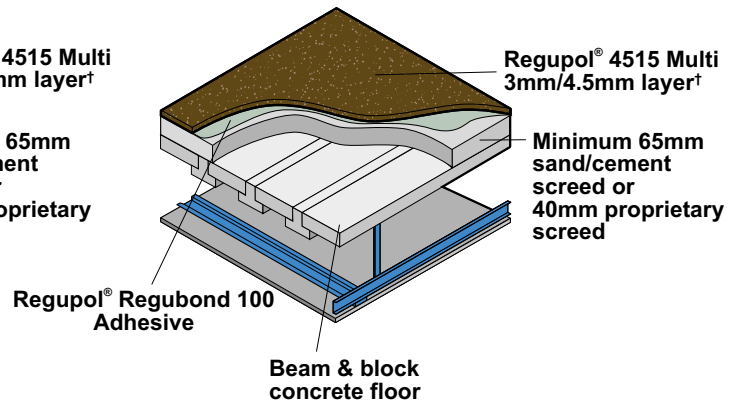

### IN-SITU CONCRETE SLAB FLOOR

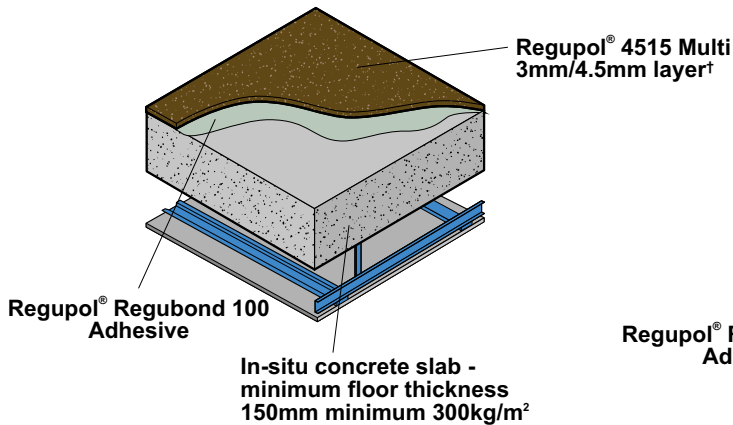

### IN-SITU CONCRETE SLAB FLOOR ON PERMANENT HOLLOW RIB STEELDECK

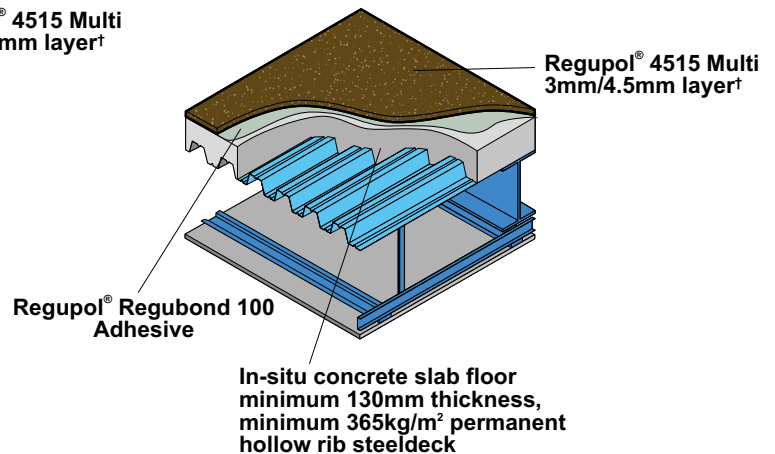

*Diagrams shown are for illustrative purposes only.*

#### Important Notes:

- Regupol® 4515 Multi must not be used on timber based constructions.

#### Important Notes relating to Underfloor Heating:

- Details shown are generic and are not specific to any single type of UFH system.
- Actual installation of the UFH system is the responsibility of the contractor and the UFH manufacturers Installation Guidelines must be followed at all times.
- Installation of the Floor Finish is the responsibility of the Flooring Contractor and the Flooring Manufacturers Installation Guidelines must be followed at all times.

## CMS DANSKIN ACOUSTICS

Scotland Office: Tel: 01698 356000 Fax: 01698 372222  
1 Netherton Road, Wishaw, ML2 0EQ

Central/Southern Office: Tel: 01925 577711 Fax: 01925 577733  
Unit 2 Lyncastle Road, Appleton, Warrington, WA4 4SN

Email: [info@cmsdanskin.co.uk](mailto:info@cmsdanskin.co.uk) Website: [www.cmsdanskin.co.uk](http://www.cmsdanskin.co.uk)

**IMPORTANT:** Directions for use are given for guidance only and are not intended to form part of any contract. They should be varied or adapted to suit your particular materials or conditions of use. Goods supplied by the company are made to approved standards from the highest quality raw materials but no warranty or guarantee is given as to their suitability for any particular purpose or application, and no liability is accepted for any loss or damage arising directly or indirectly from the use of the Company's products irrespective of any information given to us as to intended use of such products. It is therefore recommended that prospective users should test a sample of this product under their own conditions to satisfy themselves that the product is suitable for the purpose intended.

**CMSDANSKIN**  
ACOUSTICS